

MERCER

by Danao Studio



20"RD SIDE TABLE ALUMINUM

064.4101

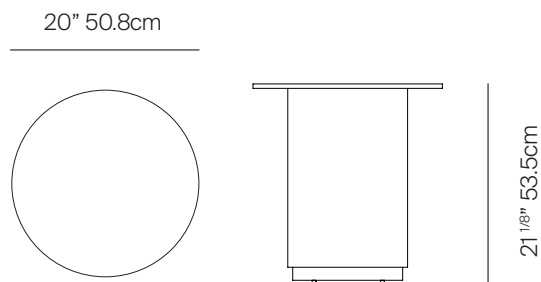

SPECIFICATIONS

Width:	20"	50.8 cm
Depth:	20"	50.8 cm
Height:	21 1/8"	53.5 cm

MATERIALS

Frame: Powder coated aluminum.
Table top: Powder coated aluminum
Furniture cover available.

FINISHES



SHELL
-45

MUSCADE
-51

ALUMINUM

TRHAW PILLOWS SOLD SEPARATELY

DANA O

danaoliving.com

20"RD SIDE TABLE ALUMINUM

064.4101

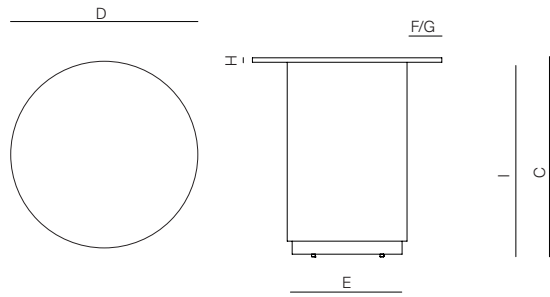

MEASURES INCH CM	OVERALL LENGTH	OVERALL WIDTH	OVERALL HEIGHT	DIAMETER	SIZE OF BASE	OVERHANG AT ENDS	OVERHANG AT SIDES	TABLE TOP THICKNESS	APRON TO FLOOR CLEARANCE	SPACE BETWEEN LEGS AT HEAD
DESCRIPTION	A	B	C	D	E	F	G	H	I	J
20"RD SIDE TABLE ALUMINUM	-	-	21 1/8	20	11 1/2	3 3/4	3 3/4	1/4	20 3/4	-
SKU# 064.4101	-	-	53.5	50.8	29.6	9.3	9.3	0.6	51.5	-

MEASURES INCH CM	SPACE BETWEEN LEGS AT SIDE	SEAT UP TO (APROX. 20"W CHAIRS SPACED 2" APART)	DIAGONAL CLEARANCE	OVERAL FURNITURE WEIGHT LBS KGS	TOTAL PIECES IN A BOX	BOXED WEIGHT LBS KGS	CUBE
DESCRIPTION	K						
20"RD SIDE TABLE ALUMINUM	-	-	26 1/2	20.9	1	31.3	8.1
SKU# 064.4101	-	-	67.3	9.5	1	14.2	

TRH OW PILLOWS SOLD SEPARATELY